

PICNIC SETTING

Designer: SPARK - Cameron Johnston



SLAT OPTIONS

- Oiled hardwood
- Composite
- Clear anodised aluminium
- Wood grain aluminium

FRAME OPTIONS

- Hot dip galvanised mild steel

FRAME FINISHES

- Galvanised
- Powdercoated

INSTALLATION

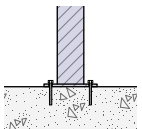

Bolt Down

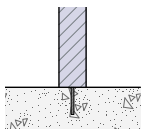

Concealed Fix

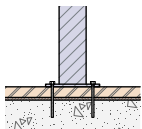

Bolt Through

FIXINGS

- 12mm fixings for 14mm diameter holes

Alternative materials and finishes available on request

GEMTREE PICNIC SETTING

SPECIFICATIONS

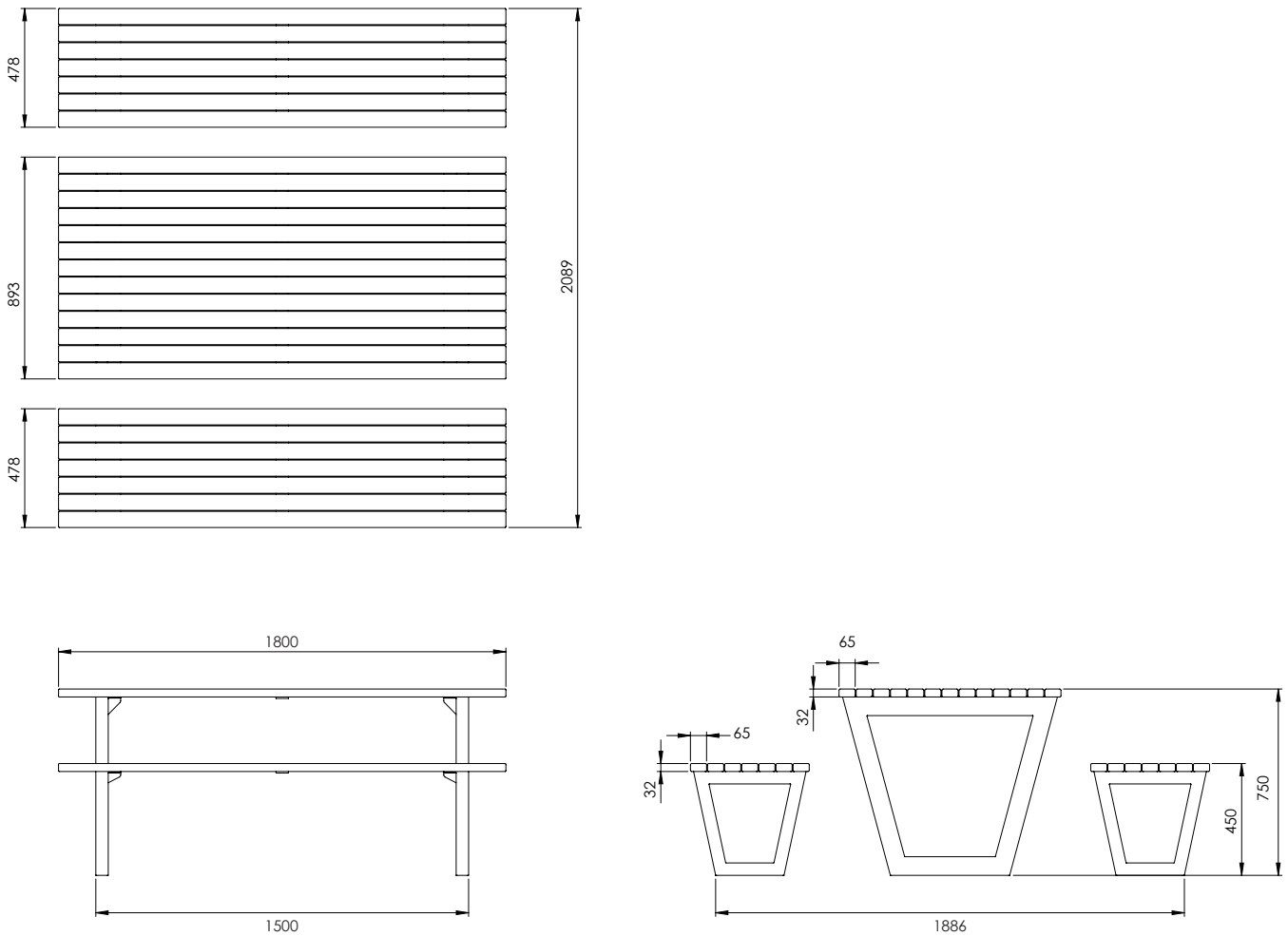

Measurements are in millimetres. Drawings are not to scale.
Dimensions shown are for timber slat option

DDA compliant version available upon request

PRODUCT CODE	FRAME FINISH	SLAT OPTION & SIZE (mm)
GMT006-HDG-GV-T	Galvanised	65x32 Oiled hardwood timber
GMT006-HDG-GV-C	Galvanised	60x40 Composite
GMT006-HDG-GV-A	Galvanised	65x35 Clear anodised aluminium
GMT006-HDG-GV-W	Galvanised	65x35 Wood grain aluminium
GMT006-HDG-PC-T	Powdercoated	65x32 Oiled hardwood timber
GMT006-HDG-PC-C	Powdercoated	60x40 Composite
GMT006-HDG-PC-A	Powdercoated	65x35 Clear anodised aluminium
GMT006-HDG-PC-W	Powdercoated	65x35 Wood grain aluminium